

### G/S Anti Down-Draft Cowl with Stainless Steel Bird mesh

Due to its distinctive shape and design, the Anti Down Cowl provides comprehensive coverage, guarding the chimney against gentle winds or air currents from any direction. This effectively prevents down-draught, ensuring that smoke does not escape from the fireplace, stove, or any other appliance.

The cowl also serves as a barrier against rain, snow, and birds, preventing them from entering the chimney. Its time-tested design ensures continuous chimney ventilation, even when the fire or appliance is not in use.

Installation is straightforward; the cowl's stem is intentionally slightly undersized to easily fit into the bore of most prefabricated metal chimneys, liners, or traditional brick chimneys. It's important to seal this joint securely.

Please ensure that the fire appliance has sufficient combustion air for proper operation.

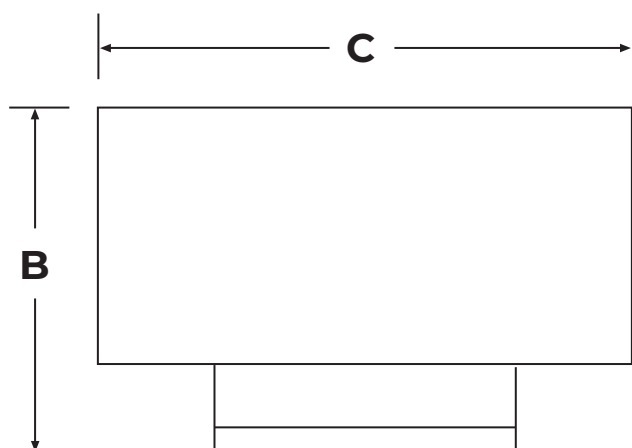

Item	Size	B	C
ADD0150	Ø150	250	350
ADD0175	Ø175	265	375
ADD0200	Ø200	275	430
ADD0250	Ø250	285	480

**Limitations of the Cowl:** The Static Anti Down Draught Chimney Cowl is not designed to counteract extremely severe and persistent downdraughts in your chimney. For such situations, we recommend using the Spinner Anti Down Draught Chimney Cowl.

Furthermore, this cowl does not address downdraught issues in windless conditions. If the problem persists when there is no wind, such as in cold, calm, and frosty weather, it indicates a lack of draught, necessitating the use of a motorized chimney cowl. It's essential to note that no anti-down draught chimney cowl can resolve a lack of draught.